

Guaranteed by the
5-2-1
promise

5 years warranty on stainless cabinet (parts only)
2 years warranty on wash pump (parts and labour)
1 year parts and labour warranty

AL8 Passthrough Warewasher

The AL8 accommodates regular 500mm dishracks plus all crates, bins, dixies etc. up to 700 wide by 540 deep by 650mm high - including many 80 litre mixer bowls.

High temperature sanitising rinse uses about 3 litres of water per cycle, regardless of cycle time, for highly efficient operation - minimising water, waste, power and chemical costs.

Operator may select 2, 4 or 6 minute cycles for rapid washing of a wide range of soil levels. Other cycle times available on request e.g. 1,2,3 minutes if your soil levels are light.

The massive 1.5 kW wash pump recirculates 800 litres of water per minute through double upper and lower wash arms for exceptional wash performance. Double filtration in the deep L shape wash tank isolates solid soil on easily removable scrap trays.

Powerful rinse booster elements ensure rapid recovery between cycles for high capacity.

Light, well balanced door with wrap around handle. Operator preselects required cycle which then auto-starts on door closure.

FASTCLEAN features include : rounded L shape wash tank, uncluttered internal design, easy-tilt rack slide, double filtration, scrap trays, stainless steel wash and rinse arms with removable end plugs, anti-drip door to channel water away from opening, and 220mm legs for excellent access beneath machine.

Electrical requirement is 25 amps 3 phase, with neutral and earth. 750mm benches are recommended. Corner installation is possible but generally not recommended.

Supplied with two dishracks, one cuprack and one cutlery basket.

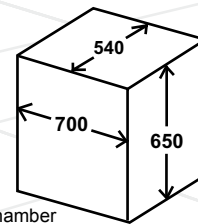

Wash Chamber



Over 25 years Washtech has earned the position of Australasia's leading wash equipment manufacturer by providing robust, reliable machines designed for ease of service and years of effective, efficient operation.



ISO 9001 certified and audited since 1993 - our equipment complies with all local hygiene, electrical and plumbing regulations including WATERMARK.



Washtech products are supported nationwide by the MOFFAT Service Network to ensure long term access to parts and after sales support and service including preventative maintenance programmes.



In line with policy to continually develop and improve it's products Moffat reserves the right to change specifications and design without notice.

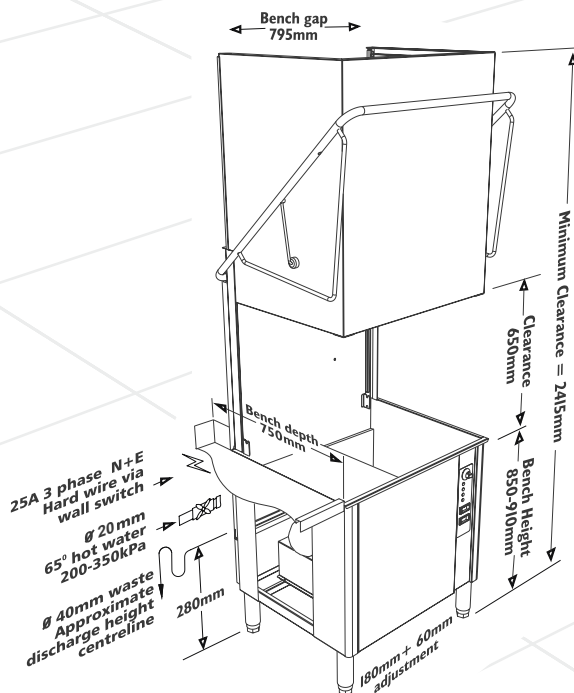

Installation drawing and detail overleaf.



www.moffat.com.au

24 HOUR SERVICE
1800 622 216

REPLACEMENT PARTS
1800 337 963

Australia Moffat Pty Limited

Victoria/Tasmania
740 Springvale Road
Mulgrave, Victoria 3170
Telephone 03 9518 3888
Facsimile 03 9518 3833
Email vsales@moffat.com.au
www.moffat.com.au

New South Wales
Telephone 02 8833 4111
Email nswsales@moffat.com.au

South Australia
Telephone 03 9518 3888
Email vsales@moffat.com.au

Queensland
Telephone 07 3630 8600
Email qldsales@moffat.com.au

Western Australia
Telephone 08 9202 6820
Email bgarcia@moffat.com.au

Effective February 2009

WASHTECH® AL8

AL8 Passthrough Warewasher

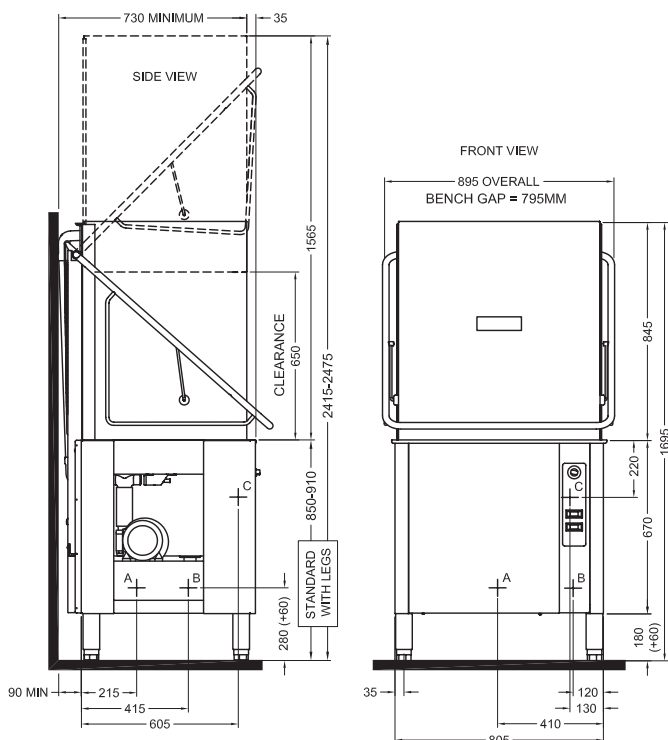

A	WATER SUPPLY
B	WASTE
C	POWER SUPPLY

KEY		AL8
M	BENCH DEPTH	750
R	RETURN	150
G	BENCH GAP	790
B	BENCH OPENING	550
F	SPLASH BEAD	50
D	RACK SIZE	500
E	RACK PATH	520
S	SINK WIDTH	450
T	CLEARANCE	35
H	DISTANCE TO WALL FOR CORNER INSTALLATION	N/A

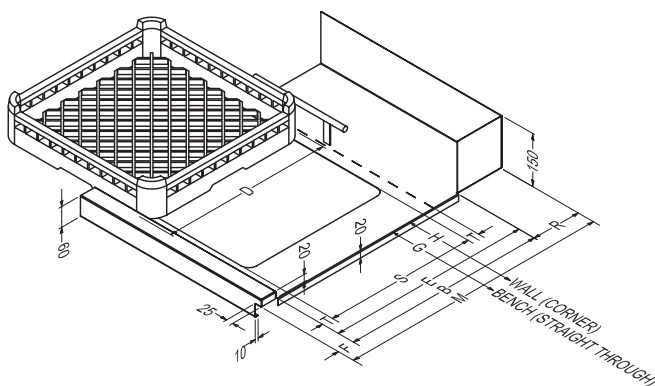

Installer must be suitably qualified and ensure compliance with all local codes and standards including AS/NZS 3500.1. Failure to comply even partially with installation instructions may void the warranty. Install machine on sound waterproof self-draining floor, with adjacent surfaces sealed against water and/or light steam. Use the adjustable feet to level the machine. Allow room for detergent to one side of machine or in adjacent cupboard. 20 litre container requires about 450H x 250W x 350D but smaller containers are available from many suppliers.

Water Supply

Hot water temperature	65°C ± 5°C
Connection	20 mm (3/4" BSP Male)
Pressure	200-350 kPa = 30-50 psi
Flow rate minimum	20 litres per minute
Consumption per cycle	3.5 litres approximately
Backflow prevention	Dual Check Valve supplied

Pressure limiter may be required. Don't use small diameter plastic supply lines. FLUSH supply line before connection. Connect supplied DCV to water supply. Poor quality supply or excessive water hardness may affect performance or damage machine - filtration and/or softening is recommended. Optional rinse booster pump available for very low pressure supply.

Waste

40mm gravity drain - refer to point B in the installation diagram - run waste directly behind the machine or through open side panels or base.

Power

Machine requires 3 Phase, Neutral and Earth, 400/415V, 25A/ph, 50Hz, permanently wired via wall switch mounted adjacent to machine. Wash pump rotation must be checked after installation to ensure correct direction (excessive noise and damage with incorrect direction).

Benchwork

Refer to relevant drawings - all dimensions in mm. Recommended bench depth is 750, height 900. Corner installation is not recommended for this model. We recommend sink smaller than rack, with guide to prevent rack falling into sink. Align sink with dishrack as shown.